

NOTE: EX50X25 BATTENS CAN BE SUBSTITUTED WITH EX50X50 WHERE APPROPRIATE

NOTE: BGC SUBSTRATE TO BE FIXED IN STRICT ACCORDANCE WITH MANUFACTURER RECOMMENDATIONS AND LITERATURE

**ATTENTION BUILDING CONSENT AUTHORITIES:** ALL PROJECTS MUST BE REGISTERED AT BUILDING CONSENT STAGE BY PHONE (0800 353 672) OR E-MAIL (info@hardasrocks.co.nz) IN ORDER FOR LICENSED APPLICATORS TO TRACK AND PRODUCER STATEMENT TO BE ISSUED UPON COMPLETION AS PER SPECIFICATION MANUAL

4e

## ROOF ABUTMENT DETAIL METAL TILE ROOFING

SCALE

NTS

DATE

23 Apr 2009

**Hard As Rocks**  
0800 353672

**PREFERRED  
DETAIL**

© 2009 HARD AS ROCKS

HARD AS ROCKS SUGGESTED DETAIL ONLY - DETAILS TO BE APPROVED BY LOCAL AUTHORITY & COMPLY WITH NZBC WHERE RELEVANT

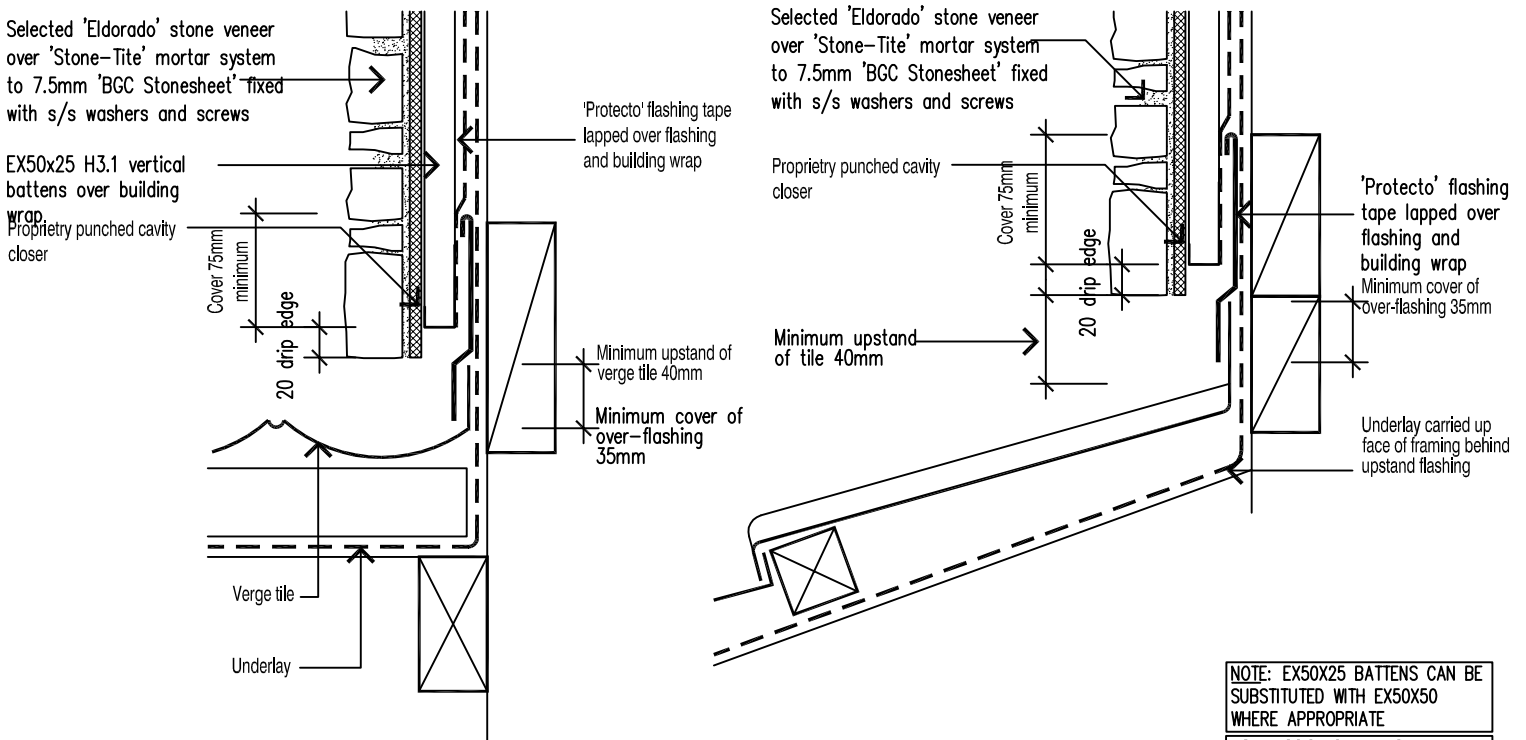

NOTE: EX50X25 BATTENS CAN BE SUBSTITUTED WITH EX50X50 WHERE APPROPRIATE

NOTE: BGC SUBSTRATE TO BE FIXED IN STRICT ACCORDANCE WITH MANUFACTURER RECOMMENDATIONS AND LITERATURE

**ATTENTION BUILDING CONSENT AUTHORITIES:** ALL PROJECTS MUST BE REGISTERED AT BUILDING CONSENT STAGE BY PHONE (0800 353 672) OR E-MAIL (info@hardasrocks.co.nz) IN ORDER FOR LICENSED APPLICATORS TO TRACK AND PRODUCER STATEMENT TO BE ISSUED UPON COMPLETION AS PER SPECIFICATION MANUAL

4f

## ROOF ABUTMENT DETAILS METAL TILE ROOFING

SCALE

NTS

DATE

23 Apr 2009

**Hard As Rocks**  
0800 353672

**PREFERRED  
DETAIL**

© 2009 HARD AS ROCKS

HARD AS ROCKS SUGGESTED DETAIL ONLY - DETAILS TO BE APPROVED BY LOCAL AUTHORITY & COMPLY WITH NZBC WHERE RELEVANT